

# Installation of Jain DripKit System

**Installation of Jain DripKit System is a very simple process. It can be divided in to three stages:**

1. Installing water source (bucket, barrel, tank etc.)
2. Laying of pipes and emitters
3. Commissioning

If there is no overhead tank then a water source must be created (i.e. a bucket, barrel, tank, etc.) It has to be installed above ground level on a stable support platform at the required height to achieve minimum pressure requirements for the system (minimum 1.5 meter). The system then can be connected to the water source.

Before operating the system, end caps at the end of the laterals and sub-main are released so that if there is dirt in the tubes it is washed away and air is also driven out. Open the control valve and let the water flow freely through the tubes for some time (flush the system). Then close the end caps and ensure that water is coming out from each emitter.



# Jain DripKit - 30 m<sup>2</sup>

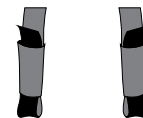
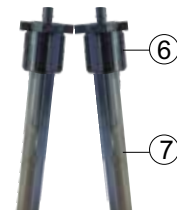
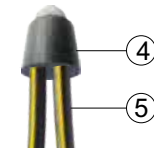
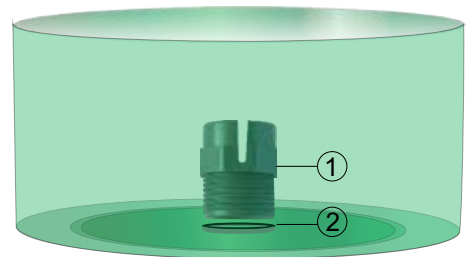
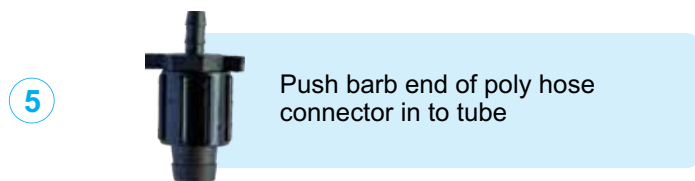
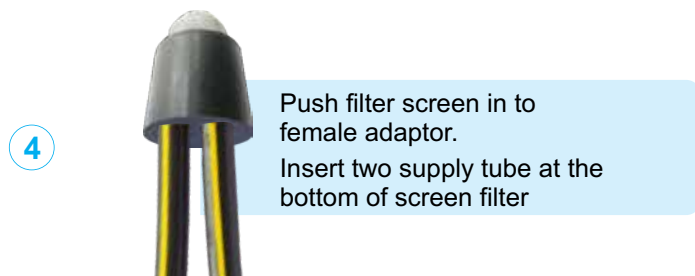
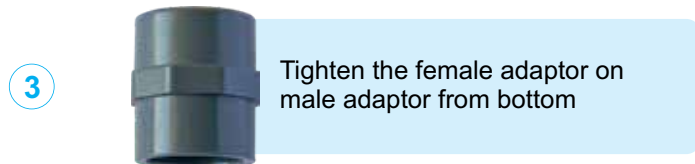
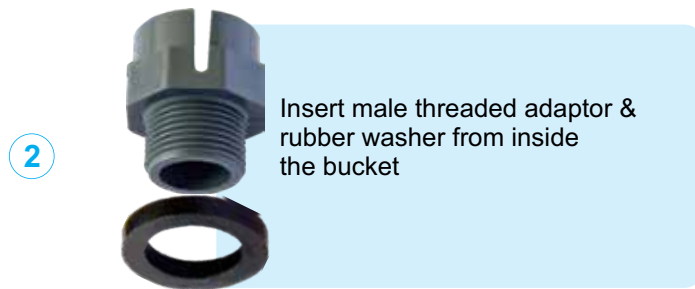
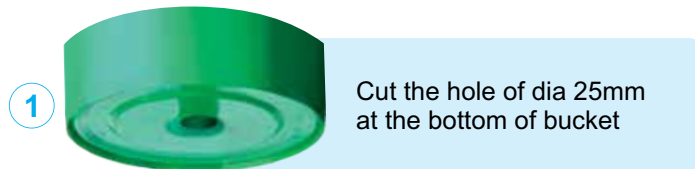

## BUCKET KIT COMPONENT

Sr.	Material Description	Code	Qty
1	Male threaded adaptor	MTA034BK	1
2	Rubber washer	RWBKF	1
3	Female adaptor	FTA 025	1
4	Bucket kit Filter	BKTFILSCN10232B	1
5	Microtube 8 mm	M08010M125	2
6	Poly Hose Connector	CPJ0816	2
7	Drip Tape (in meter)	DLX16063022330	30

6

Unscrew the cap of connector  
push the drip tape & tighten the cap.

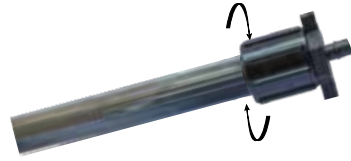

7

To close the ends

- Cut approximate 3" length of Chapin Tube to use it as an end cap.
- Fold the tape (minimum 3 to 4 folds)
- Squeeze it lengthwise.
- Insert tape in to sleeve made from small piece of tape.

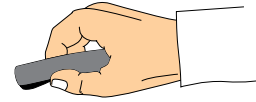

Fill the water in to bucket,  
if impurities are present in water,  
Filter through heavy cloth.

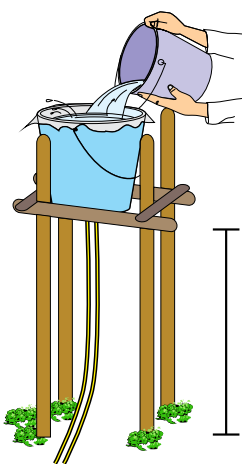

Minimum  
1.5 Meter

Maintain height  
of bucket at least  
1.5 meter  
from the ground.

Schematic Layout

