

Chapin® BTF

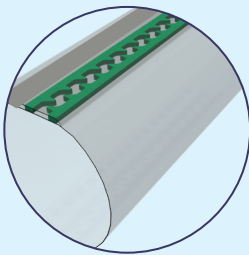

Precision Formed Drip Tape

Manufactured from unique extruded film profile with extra strength.

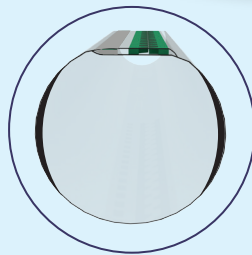

Resistance to Abrasion and Insect Damage

Rounded and thickened tape edges provides protection against abrasion and insect damage

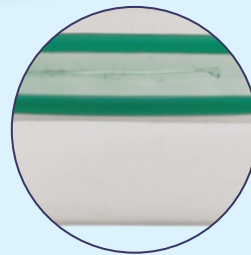

Slit Outlet

Slit outlet prevents root intrusion and soil ingress.

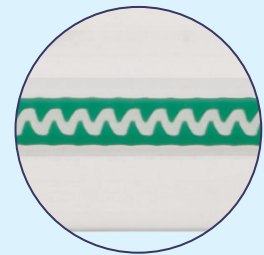

Clog Resistant Flow Path Design

Hydraulically efficient, high vortex, turbulent flow path with large cross sectional area. Longer flow path ensures true drip flow - no squirts.

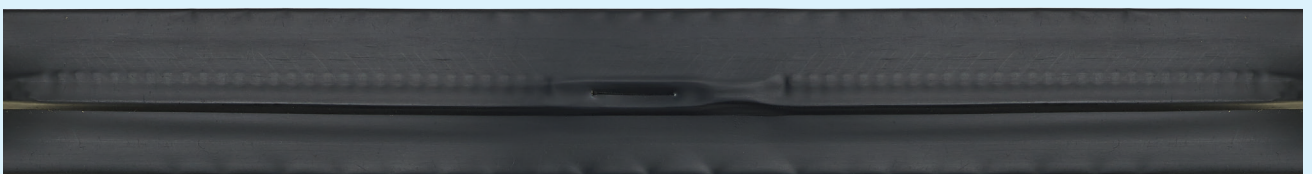

CHAPIN® BTF - Technical Specification

Technical Specifications - Metric

Nominal Diameter (mm)	Spacing (cm)	lph/ mtr		lph/outlet	
		0.7 kg/cm ²	1.0 kg/cm ²	0.7 kg/cm ²	1.0 kg/cm ²
16, 22	10	9.90	12	1.01	1.2
	15	3.72, 4.84, 9.90	4.5, 5.9, 11.9	0.57, 0.74, 1.51	0.68, 9.88, 1.79
	20	3.72, 4.84, 6.33	4.5, 5.8, 7.7	0.76, 0.98, 1.29	0.90, 1.16, 1.53
	30	2.98, 3.72	3.6, 4.5	0.91, 1.13	1.08, 1.34

Note: Nominal discharge may vary w.r.t. tube wall thickness and other processing parameters.

Technical Specifications - US

Nominal Diameter (inch)	Spacing (inch)	gpm/100 ft		gph/outlet	
		10 psi	14 psi	10 psi	14 psi
5/8, 7/8	4	1.33	1.6	0.27	0.32
	6	0.5, 0.65, 1.33	0.6, 0.8, 1.6	0.15, 0.2, 0.4	0.18, 0.23, 0.47
	8	0.5, 0.65, 0.85	0.6, 0.8, 1.0	0.2, 0.26, 0.34	0.24, 0.31, 0.40
	12	0.4, 0.5	0.5, 0.6	0.24, 0.3	0.29, 0.35

Note: Nominal discharge may vary w.r.t. tube wall thickness and other processing parameters.

Coil Lengths

Nominal Diameter		Wall Thickness		Coil Lengths	
(mm)	(inch)	(mm)	(mil)	(m)	(ft.)
16	5/8	0.15	6	3049	10000
		0.20	8	2287	7500
		0.25	10	1829	6000
		0.30	12	1524	5000
		0.38	15	1220	4000
		0.5	20	915	3000
		0.60	24	762	2500
22	7/8	0.15	6	2287	7500
		0.20	8	1677	5500
		0.25	10	1372	4500
		0.30	12	1067	3500
		0.38	15	915	3000

Note: 1 mil = 1/1000th part of an inch = 0.0254 mm

* Coil lengths are for coil size 560 x 270 mm (22" x 10.6"). Other coil sizes such as 350x150 mm (13.8" x 5.9") and 560x150 mm (22" x 5.9") are also available.



CHAPIN® BTF - Running Length Chart

16 mm Tape - 15.9 mm Internal Diameter

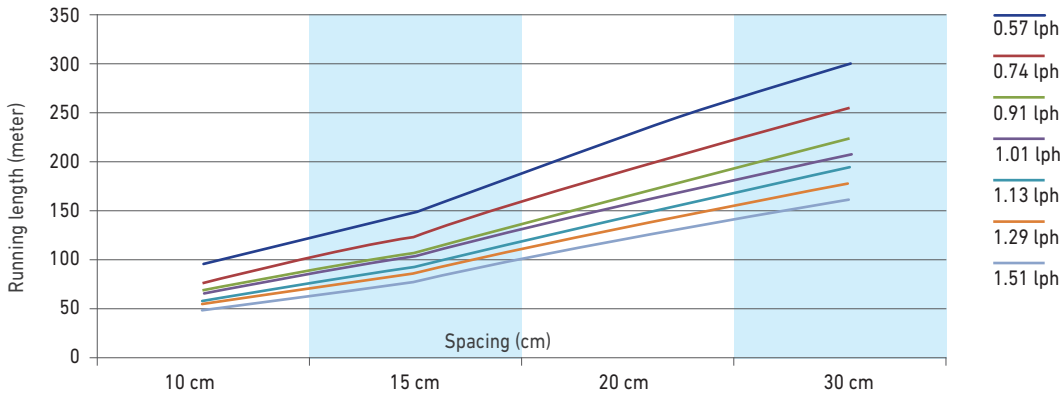

22 mm Tape - 22.2 mm Internal Diameter

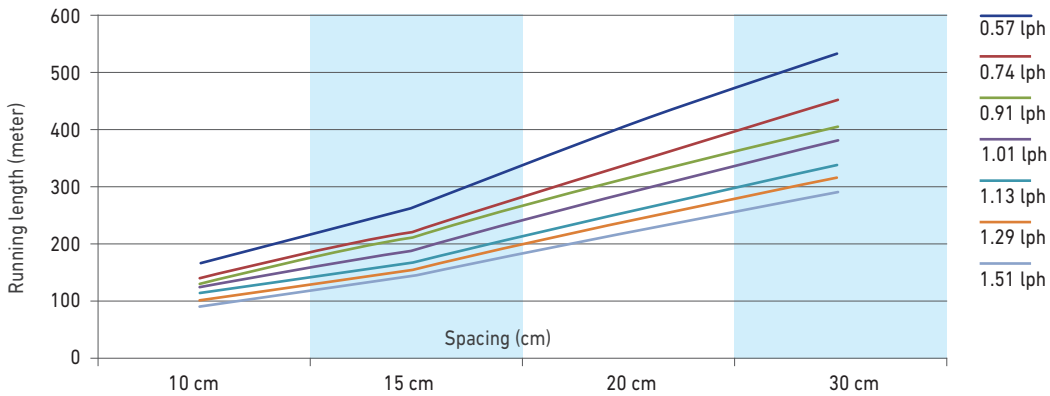

Note: All of the above mentioned charts are for 0 % Slope and is for 20 % hed variation.



